

### SCAFFOLD ERECTION NOTES

**EDGE PROTECTION**  
ENSURE THAT DOUBLE GUARDRAILS AND TOE BOARDS ARE FIXED TO ALL WORKING PLATFORMS AND SINGLE GUARDRAIL ON ALL INTERMEDIATE PLATFORMS. SCAFFOLD ERECTION IN ACCORDANCE WITH THE LATEST CURRENT SG 4.

**STANDARDS**  
MAXIMUM LIFT HEIGHT 2000mm.

**TRANSOMS**  
TRANSOMS CENTRES OF 1000mm MUST NOT BE EXCEEDED WITH ADDITIONAL TRANSOMS AT BOARD JOINTS. MAXIMUM TRANSOM SPAN 1000mm. BOARDS SHORTER THAN 1200mm TO HAVE A MINIMUM OF 3 TRANSOM.

**LEDGERS**  
MAXIMUM LEDGER SPAN 2100mm.

**PUNCHEONS**  
PUNCHEONS INDICATED THUS. FIX TO BOTH CHORDS OF BEAMS USING LOAD BEARING COUPLERS.

**CLASS 'B' COUPLERS**  
ONLY CLASS 'B' COUPLERS TO BE USED.

**BOARDS**  
USE 38mm SCAFFOLD BOARDS. SHORT BOARDS (LESS THAN 2400mm) TO BE FIXED DOWN USING BOARD CLAMPS. BOARD OVERHANG TO BE BETWEEN 50mm AND 150mm MAX.

**BRACING**  
BRACES FIXED TO BAYS INDICATED USING LOAD BEARING COUPLERS.

**USE 450 ALLOY BEAMS**  
TOP CHORD RESTRAINT @ 1.0M C/C MAX.  
BOTTOM CHORD RESTRAINT @ 2.0M C/C MAX.  
LATERAL BRACING AT @ 2.0M C/C MAX.  
PLAN BRACE FULL LENGTH UNDER TOP CHORD.  
FIX ALL STANDARDS, DROP TUBES OR PUNCHEONS TO BOTH CHORDS USING LOAD BEARING COUPLERS.  
FIX SUPPLEMENTARY COUPLERS AS INDICATED.  
AT SUPPORTS FIX LACING TUBES TO STANDARDS BELOW THE BEAM CHORDS. AT PUNCHEONS AND DROP TUBES FIX LACING TO TUBES ABOVE THE BEAM CHORDS.

**TIES**  
TIES TO BE FIXED IN POSITIONS INDICATED THUS. SEE TIE DETAIL FOR ARRANGEMENT / TYPE.

**LIP TIES**  
TIES TO BE FIXED IN POSITIONS INDICATED THUS. SEE TIE DETAIL FOR ARRANGEMENT / TYPE.

**DEBRIS NETTING**  
SECURE DEBRIS NETTING TO INSIDE OF THE EXTERNAL PERIMETER OF SCAFFOLD USING CABLE TIES.

THIS DRAWING IS CONFIDENTIAL AND IS THE EXCLUSIVE PROPERTY OF EMBASSY SITE SERVICES. NO UNAUTHORISED USE, COPY OR DISCLOSURE IS TO BE MADE AND IS TO BE RETURNED UPON REQUEST.  
ALL RESUME ISSUES BY EMBASSY SITE SERVICES ARE FOR CONSTRUCTION BY BIDD ONLY. THE SCAFFOLD STRUCTURES THAT EMBASSY CONSTRUCTION ARE COVERED BY PROFESSIONAL INDEMNITY INSURANCE. EMBASSY WILL NOT ACCEPT RESPONSIBILITY FOR ANY LOSSES, DAMAGES OR INJURY ARISING FROM THE USE OF ANY DESIGN FOR CONSTRUCTION BY ANY PARTY OTHER THAN EMBASSY SITE SERVICES.  
ALL DIMENSIONS ARE AS STATED OR AS CALCULATED. WRITTEN DIMENSIONS SHALL TAKE PRECEDENCE OVER SCALED DIMENSIONS. DIMENSIONS IN MM UNLESS STATED OTHERWISE (USED).  
CONSTRUCTION IN ACCORDANCE WITH BS EN 12811-1 AND MANUFACTURERS GUIDELINES.  
ALL TUBES TO BE STEEL IN ACCORDANCE WITH BS EN 20, UNLESS NOTED OTHERWISE (USED). ALL COUPLERS TO COMPLY WITH BS EN 20, UNLESS NOTED OTHERWISE (USED).  
ALL BOARDS TO COMPLY WITH BS EN 12811-1 UNLESS NOTED OTHERWISE (USED). SCAFFOLD ERECTION AND DEMANTING TO COMPLY WITH THE CURRENT REVISION OF SG 4.  
EN 12811-1 - THE CONSTRUCTION DESIGN AND MANAGEMENT REGULATIONS 2015  
IN ORDER TO ELIMINATE, REDUCE AND CONTROL RISK, SAFETY, HEALTH AND THE DESIGN RISK ASSESSMENT HAVE BEEN CONSIDERED IN THE PREPARATION / PRODUCTION OF THIS DESIGN THROUGH CO-OPERATION AND CO-ORDINATION WITH OTHERS.  
SOME RESIDUAL HAZARDS / RISKS MAY REMAIN. THESE ARE IDENTIFIED WITH A HAZARD SYMBOL AND REFERENCE. EMBASSY OPERATOR MANAGERS AND / OR THE CLIENTS SHOULD ASSESS AND MANAGE THESE RESIDUAL HAZARDS / RISKS. (IF APPLICABLE REFER TO THE DESIGN RISK ASSESSMENT).

**MAXIMUM ALLOWABLE LIVE LOADS**  
1.50kN/m<sup>2</sup> ON 1 No. WORKING PLATFORM (S)  
0.75kN/m<sup>2</sup> ON 1 No. INSIDE BOARD (S)

**ENVIRONMENTAL LOADS**  
0.25kN/m<sup>2</sup> PEAK WIND VELOCITY PRESSURE  
APRIL PERIOD OF ERECTION  
16 WEEKS MAXIMUM DURATION OF SCAFFOLD

**INTERFACE LOADS**  
11.01kN MAXIMUM VERTICAL POINT LOAD  
3.48kN CALCULATED HORIZONTAL TIE LOAD

**TIE LOAD TESTING**  
4.50 kN PROOF TEST (F.O.S. 1.25 : 1)  
PROOF TEST 3 No. OR 5% OF TIES (WHICHEVER IS GREATER)

7.00 kN PRELIMINARY TEST LOAD (F.O.S. 2 : 1)  
5 No. ANCHORS IN ALTERNATIVE LOCATION - NOT TO BE USED.

**ASSOCIATED DOCUMENTATION**  
15257-ESS-0022-CAL CALCULATION  
15257-ESS-0022DRA DESIGNERS RISK ASSESSMENT

C02	REV A ISSUED FOR CONSTRUCTION	MW	10.05.23
A01	ISSUED FOR APPROVAL	MW	21.04.23
REV	DESCRIPTION	BY	DATE

CLIENT  
**WATES**

TITLE  
**ACCESS SCAFFOLD**

SITE  
**BUCKINGHAM ROAD**

SCALE	1:50 @ A1	DRAWN BY	M.WARD	21.04.23
PRELIMINARY APPROVAL BY	00.00.00	CHECKED BY	00.00.00	00.00.00

DRAWING STATUS  
○ ISSUED FOR APPROVAL  
○ ISSUED FOR CONSTRUCTION

CONTRACT	DIVISION	DESIGN REF	DOCUMENT SHEET	STATUS
15257-ESS	-	0022 - DRG - 01 - C	rev 02	

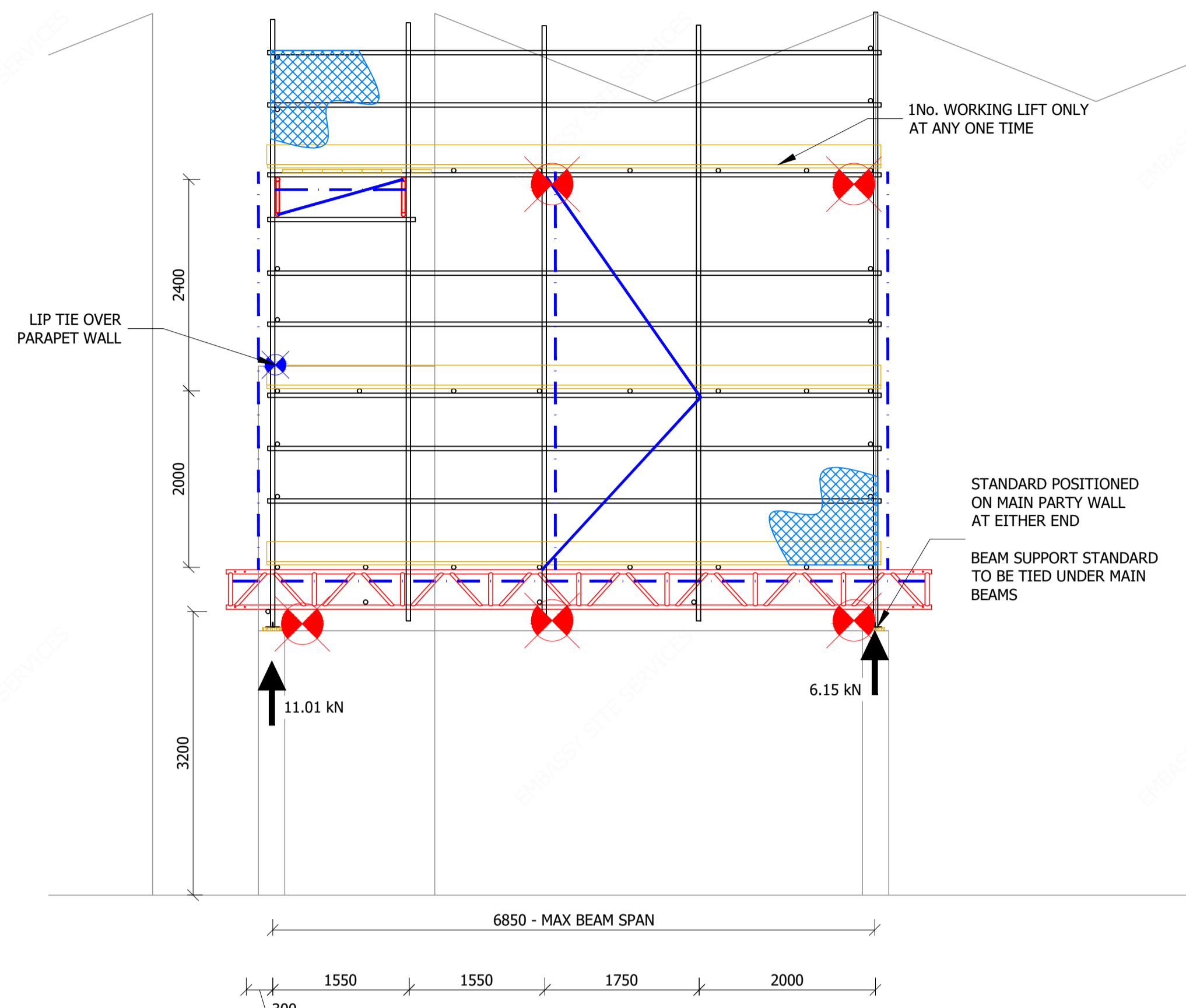

**SECTION A-A**

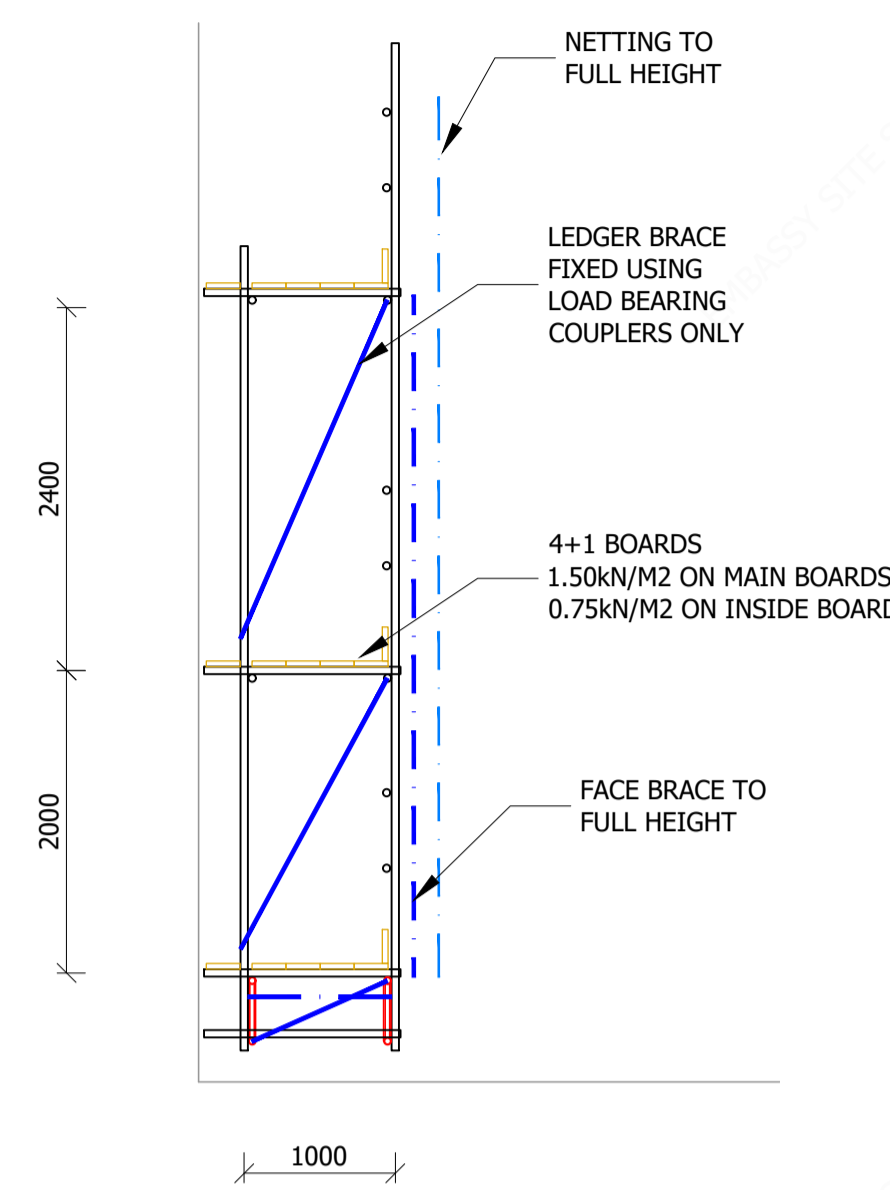

**SECTION B-B**

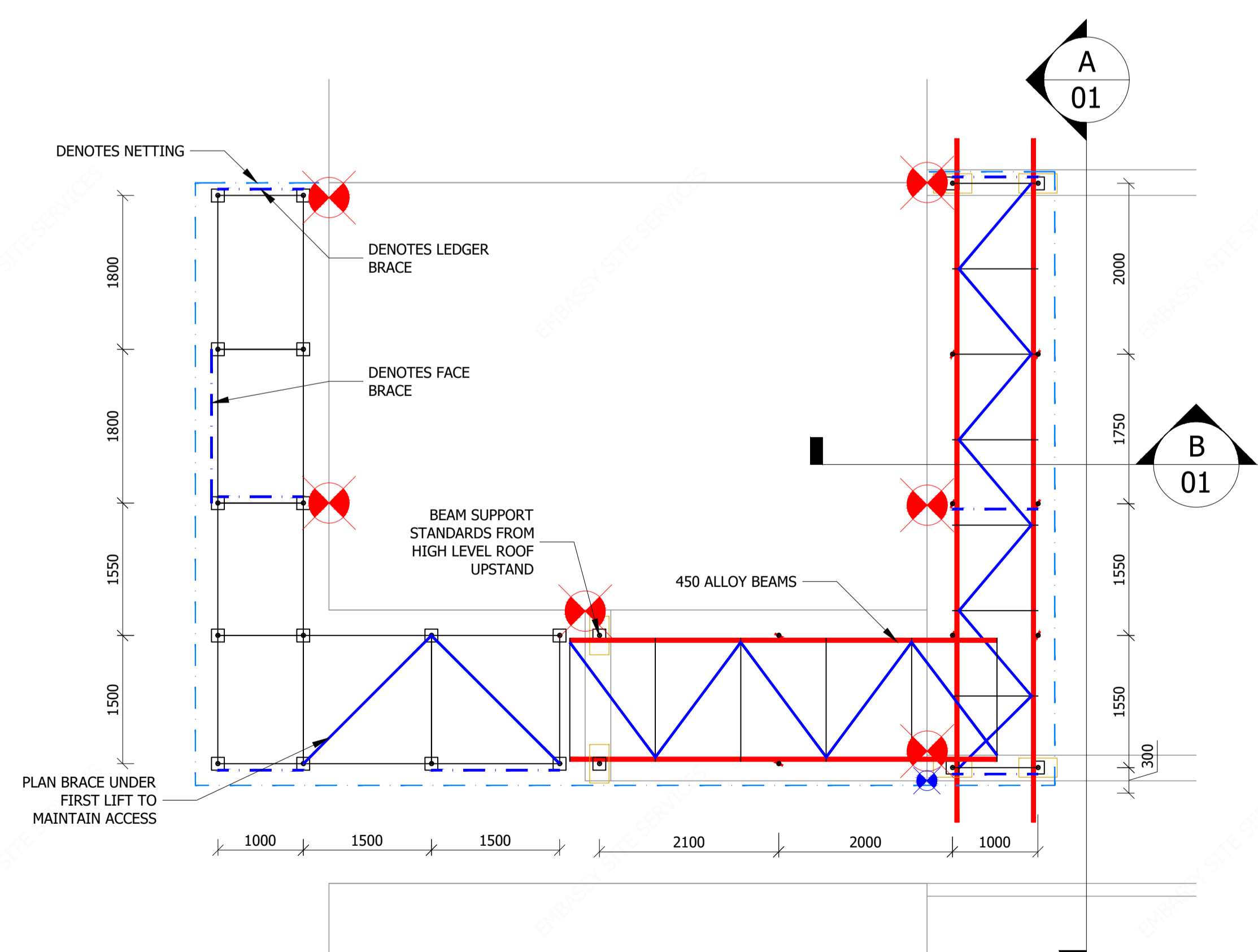

**PLAN VIEW**

BOARDS AND BOARD BEARING TRANSOMS OMITTED FOR CLARITY

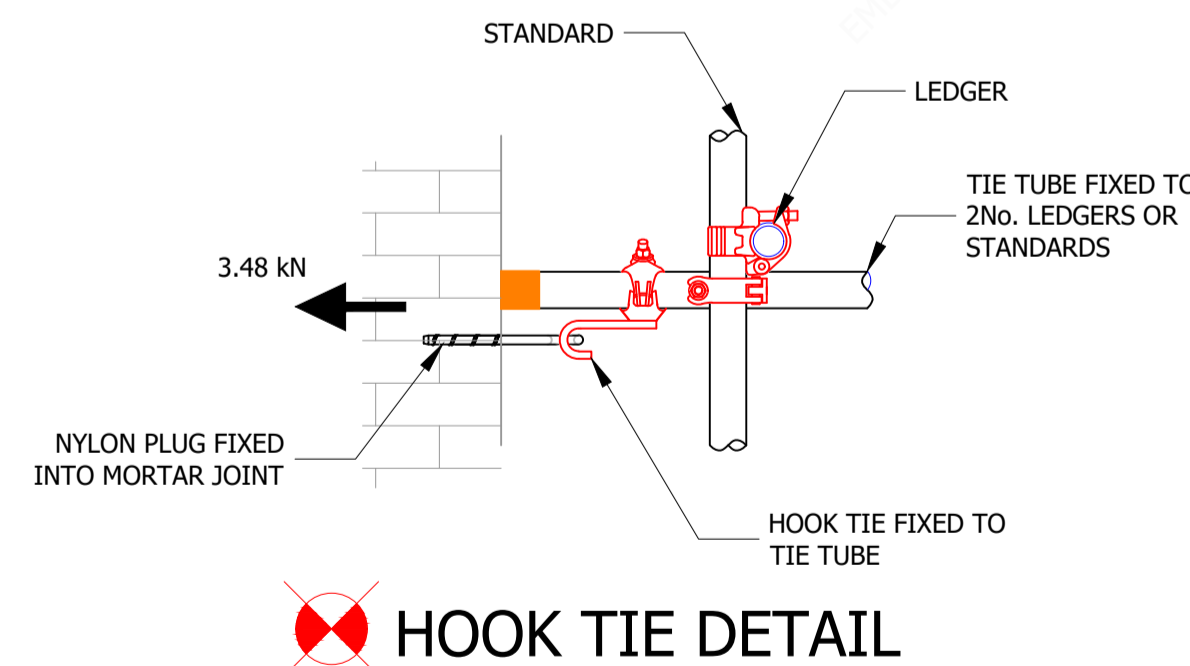

**HOOK TIE DETAIL**

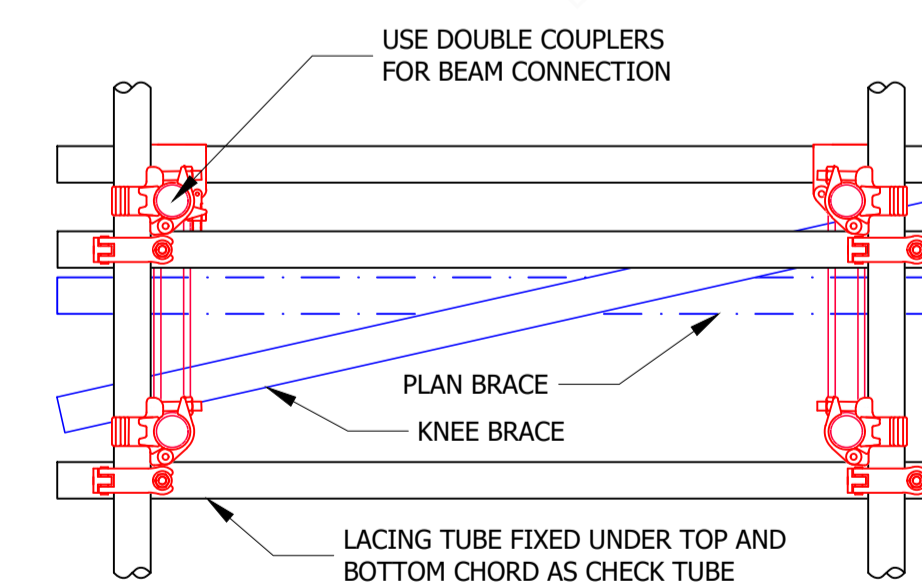

**BEAM CONNECTION DETAIL**